

Production Code?

The production code number is found in the location shown below. Please write the production codes of your Bikes into the Maintenance Activity Checklists on page 18 and page 19.

Production Code:

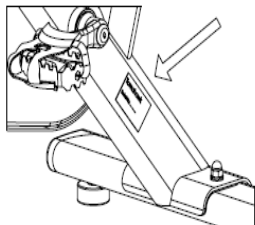

QUESTIONS?

At TOMAHAWK, we are committed to providing complete customer satisfaction. If you have questions, please contact your local distributor or refer to our Web-Site

www.indoorcycling.com

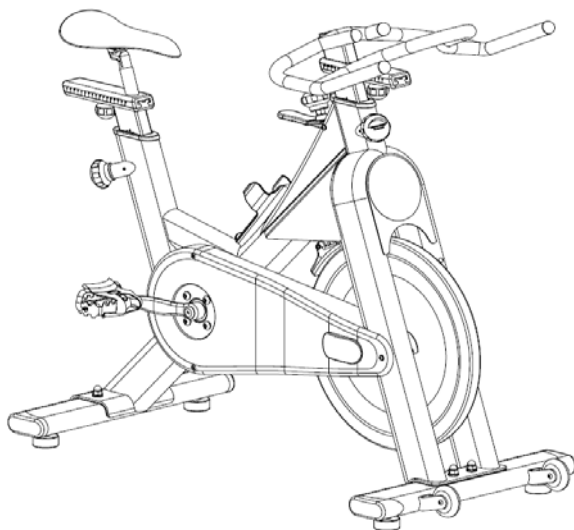

CAUTION !

Read all precautions and instructions in this manual before using this equipment. Keep this manual for future reference.

Improper assembly, maintenance or use can void the warranty terms.

TABLE OF CONTENTS

Important Precautions	page 3
Before You Begin	page 4
How to Assemble the Indoor cycle	page 5-8
How to Adjust the Indoor cycle	page 9
Pedal Strap Adjustment	page 9
Saddle Height Adjustment	page 9
Saddle Horizontal Adjustment	page 10
Handlebar Adjustment	page 11
Resistance Adjustment	page 12
How to Move the Indoor cycle	page 12
Preventative Maintenance	page 13
Daily Maintenance	page 13
Weekly Maintenance	page 13
Bi-weekly Maintenance	page 13-14
Monthly Maintenance	page 15-17
Maintenance Activity Plan & Checklists	page 18-19
Explosion Drawings of Structural Components	page 20-26
Spare Part Reference List	page 27
Limited Warranty S – X Series	page 28 - 30

The Tomahawk team thanks you for believing in our promise to provide you the best in indoor cycling and make you part of the ***Tomahawk Difference.***

IMPORTANT PRECAUTIONS

WARNING:

To reduce the risk of serious injury, read the following important precautions and information before operating the indoor cycle.

1. It is the responsibility of the owner to ensure that all users of the indoor cycle are informed of all warnings and precautions.
2. Operate and maintain the indoor cycle only as described in this manual.
3. Do not operate the indoor cycle until it is properly assembled (see page 5-8).
4. Keep the indoor cycle indoors, away from moisture and dust. Do not place the indoor cycle in a garage or covered patio or near water.
5. Place the indoor cycle on a level surface. To protect the floor or carpet from damage, place a mat beneath the indoor cycle. Make sure that there is adequate room around the indoor cycle to mount, dismount, and operate it.
6. Regularly inspect and properly tighten all parts of the indoor cycle as recommended in this manual.
7. Children under the age of 18 should only be allowed use of the indoor cycle with parental consent and guided by a specially trained instructor.
8. The indoor cycle should not be used by persons weighing more than 350 pounds (158 kg).
9. Always wear appropriate athletic clothes and shoes while operating the indoor cycle. Do not wear loose clothes that could become caught on the indoor cycle or shoes with loose laces.
10. Before using the indoor cycle, make sure that you are familiar with the operation of the indoor cycle (see pages 9-12).
11. The indoor cycle does not have an independently moving flywheel (wheel); the pedals will continue to move together with the flywheel until the flywheel stops.
12. Always regulate the flywheel resistance so that your pedalling motion is controlled (see page 12).
13. Keep your back straight while using the indoor cycle; do not arch your back.
14. If you feel pain or dizziness while exercising, stop immediately, rest and cool down.
15. If replacement parts are needed, use only manufacturer supplied parts.

WARNING:

Before beginning this or any exercise program, consult your physician. This is especially important for persons over the age of 35 or persons with pre-existing health problems. Read all instructions before using. The manufacturer assumes no responsibility for personal injury or property damage sustained by or through the use of this product.

BEFORE YOU BEGIN

Congratulations for selecting the TOMAHAWK indoor cycle. The TOMAHAWK indoor cycle offers an impressive array of features designed to enhance cardiovascular fitness, tone muscles, and develop endurance. Whether users are beginners or experienced athletes, the indoor cycle offers workouts that will help users to reach their individual fitness goals.

IMPORTANT: Read this manual carefully before assembling or using the indoor cycle. If you have questions after reading this manual, please contact your local distributor or refer to the website www.indoorcycling.com. Before reading further, please familiarize yourself with the parts that are labeled in the drawing below.

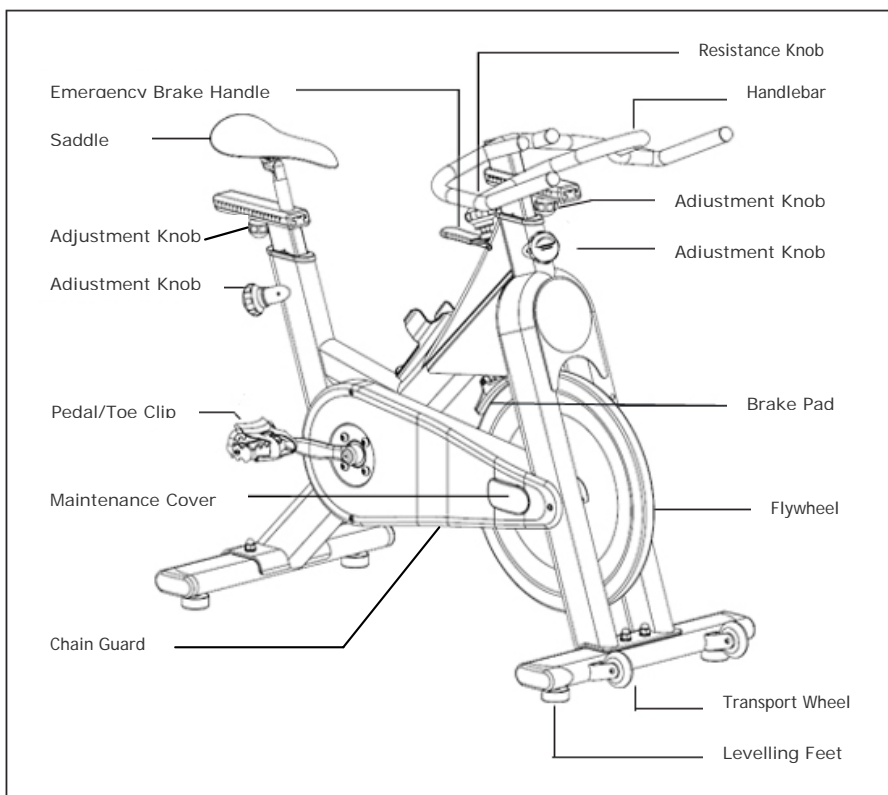

HOW TO ASSEMBLE THE INDOOR CYCLE

Due to the weight of the indoor cycle, it is recommended that two persons perform the assembly. Set the studio cycle in a cleared area and remove all packing materials; do not dispose of the packing materials until assembly is completed.

1. Identify the Rear Stabilizer (02 11 02). Orient the Rear Stabilizer so the widest parts of the Stabilizer End caps (02 11 06) are at the rear.

While a second person lifts the rear of the Frame, attach the Rear Stabilizer to the Frame with two M10 x 60mm Bolts, four M10 Washers, a Stabilizer Gasket (02 11 E), two Plastic Washers (A), and two M10 Cap Nuts as shown (Stabilizer mounting kit 02 11 B).

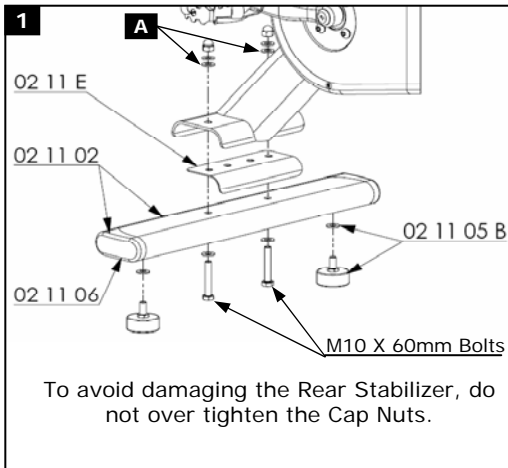

2. Orient the Front Stabilizer (02 11 01) so the widest parts of the Stabilizer End caps are at the front.

While a second person lifts the front of the Frame, attach the Front Stabilizer to the Frame with two M10 x 60mm Bolts, four M10 Washers, a Stabilizer Gasket (02 11 E), two Plastic Washers (A), and two M10 Cap Nuts (Stabilizer mounting kit 02 11 B).

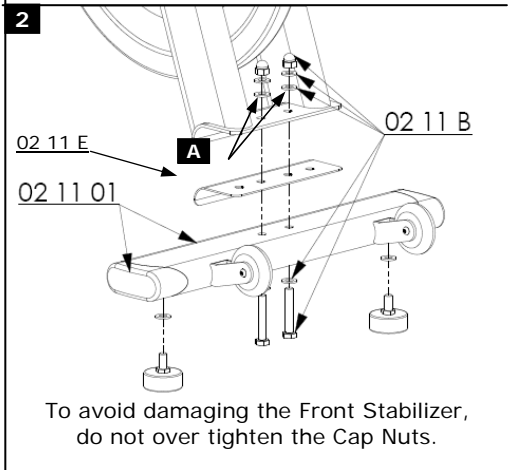

It is important that the plastic washers (A) used on front and rear stabilisers are mounted in the correct manner, please also refer to page 24.

3. Turn the rear Adjustment Knob (02 10 B) counter clockwise and insert the Saddle Post (02 21 06 SX) into the Frame. Next, bring the Saddle Post to the desired height, and turn the Adjustment Knob clockwise to retighten until it is snug.

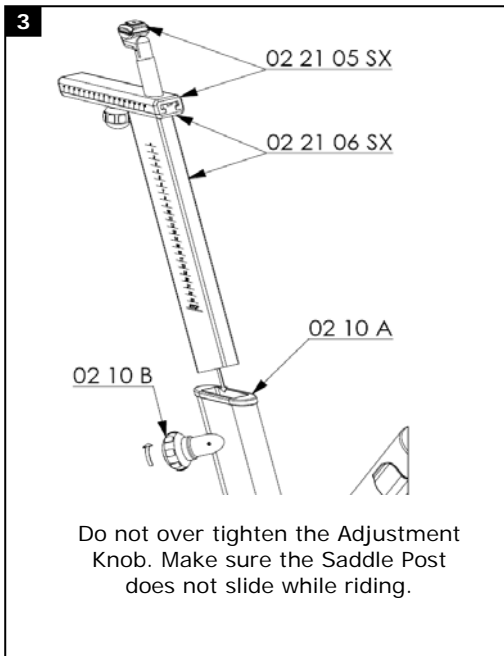

Do not over tighten the Adjustment Knob. Make sure the Saddle Post does not slide while riding.

4. Loosen the M8 Bolt on the lower side of the aluminium saddle bracket (02 20 03) several turns without removing it. Next, turn the upper part of the Saddle Clamp (A) one quarter of a turn, and set the rails of the Saddle (01 21 VL-3134) in the grooves of the Lower Saddle Clamp (02 20 03). Then, lift the Upper Saddle Clamp, turn it back to its original position, and set it on top of the rails. Finally, firmly retighten the Bolt and make sure that the saddle is mounted in its most horizontal position at the middle of the rail.

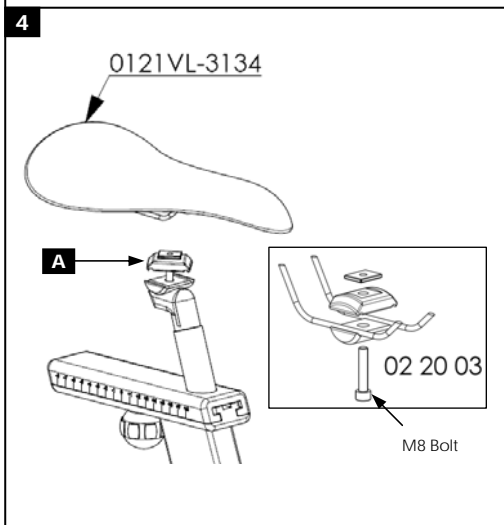

For details please refer to page 25

5. Turn the front Adjustment Knob (02 10 B) counter clockwise, and insert the Handlebar Post (02 30 05 SX) into the Frame. Next, bring the Handlebar Post to the desired height, and turn the Adjustment Knob clockwise to retighten until it is snug.

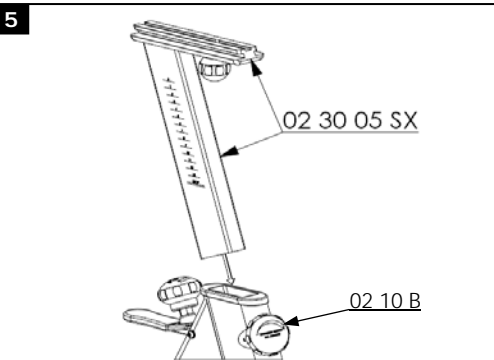

Do not over tighten the Adjustment Knob. Make sure the Handlebar Post does not slide while riding.

6. Set the stop block (02 30 06) in the indicated hole in the lower part of the Handlebar slider. Next, loosen the Adjustment Knob (02 10 D) in the Handlebar Post.

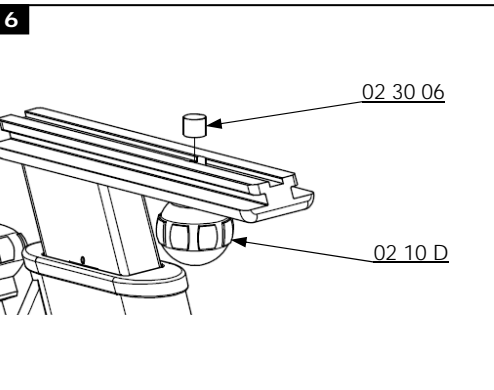

7. Remove the front M8 x 8mm grub screw (02 30 06) from the upper part of the Handlebar slider (02 30 02 SX). Slide the Handlebar onto the Handlebar Post until it stops.

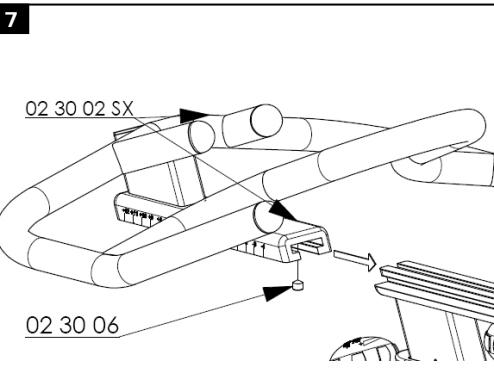

8. Reattach the front grub screw back into the Handlebar until the end of the grub Screw (02 30 06) almost touches the Handlebar Post.

Finally, Slide the Handlebar to the desired position, and retighten the Adjustment Knob.

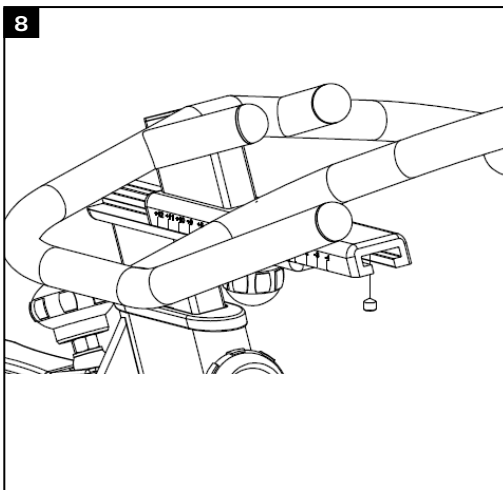

9. Identify the Right Pedal. Carefully insert the Right Pedal into the Crank Arm by turning by hand clockwise assuring that it enters horizontally aligned. Using a 15mm pedal wrench, firmly tighten the Right Pedal clockwise into the Right Crank Arm. Repeat the same procedure for the Left Pedal but in a counter Clockwise motion.

To avoid damaging the indoor cycle, use only a 15mm pedal wrench to attach the Pedals.

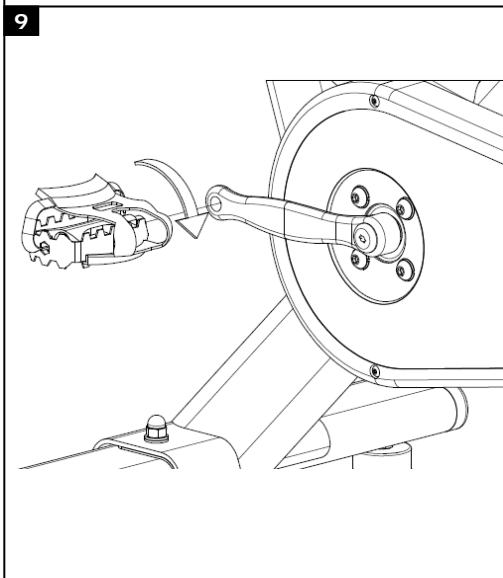

10. Make sure that all parts are properly tightened before the indoor cycle is used. To protect the floor or carpet, place a mat under the indoor cycle.

HOW TO ADJUST THE INDOOR CYCLE

The indoor cycle can be adjusted for maximum comfort and exercise effectiveness. The instructions below describe one approach to adjusting the indoor cycle; you may choose to adjust the indoor cycle differently.

PEDAL STRAP ADJUSTMENT

Sit on the saddle and position your feet on the pedals, with the balls of your feet directly above the spindles of the pedals (see the drawing below). Adjust the pedal straps so the toe clips (cages) are snug but not too tight. Note: In the case of a Bike being fitted with Combi-pedals (optional on the S series and Standard on the X Series), the pedals feature toe clips on one surface and SPD cleats on the opposite surface. If desired, use the SPD cleats with cycling shoes instead of the toe clips.

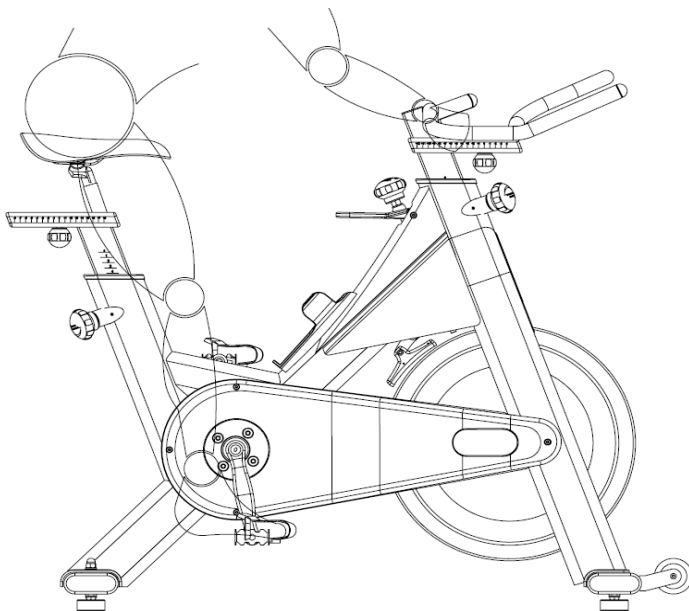

SADDLE HEIGHT ADJUSTMENT

Sit on the saddle and slowly pedal until the right pedal is in the lowest position. Your knees should be slightly bent without a dropping of the hips. **To avoid hyper extending your knees, make sure that your legs are not completely straight.**

SADDLE HORIZONTAL ADJUSTMENT

Proper horizontal adjustment of the saddle is very important in avoiding injury to the knees. Sit on the saddle and move the pedals until the crank arms are in horizontal position.

Using your forward most leg as a marker, your kneecap should be directly above the center of the pedal so that a straight line is created between knee and center of the pedal (see the dotted line in image below). To adjust the horizontal position of the saddle, first dismount the indoor cycle. Next, loosen the rear adjustment knob, slide the saddle forward or backward as required, and then retighten the knob.

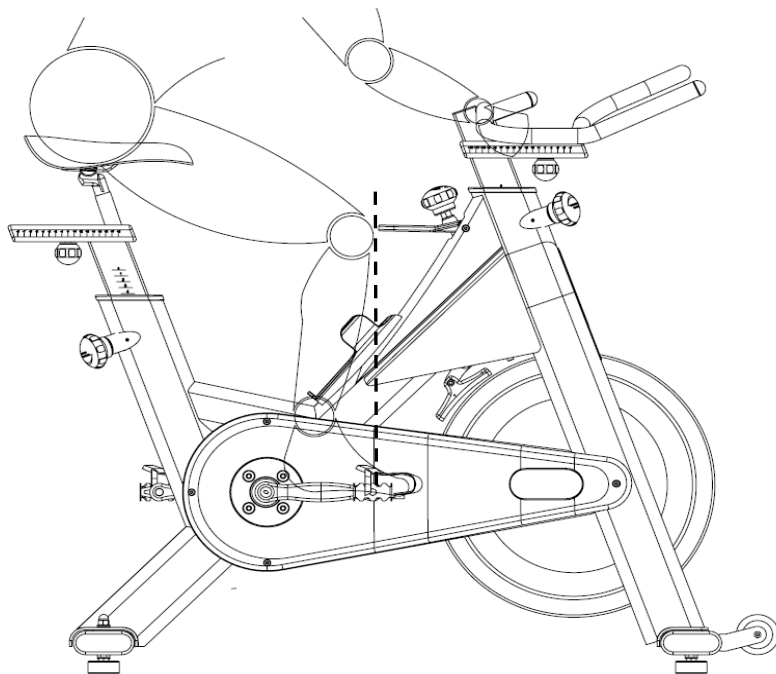

HANDLEBAR ADJUSTMENT

Begin with the top of the handlebar at relatively the same height or just slightly higher than the top of the saddle (dotted horizontal line A in the drawing below) and at a neutral fore/aft position (see dotted vertical line B in drawing below). If your knees touch the handlebars or if you experience back discomfort while pedalling for extended periods of time, the height of the handlebars can be adjusted. First, dismount the indoor cycle. Next, turn the front adjustment knob counter clockwise, slide the handlebar post up or down, and then retighten the adjustment knob.

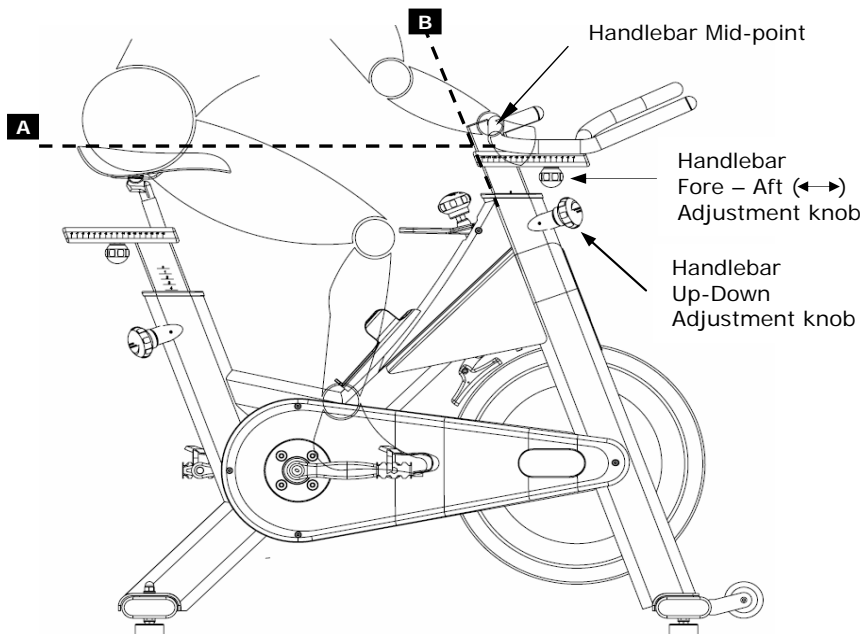

Next, the horizontal position of the handlebars should be adjusted. If the handlebars are too close to the saddle, your breathing may feel restricted; if the handlebars are too far from the saddle, you may experience back discomfort. To adjust the horizontal position of the handlebars, first dismount the indoor cycle. Check for proper handlebar position by positioning your elbow so that it is touching the front tip of the saddle at a 90 degree angle (└●) and checking that the fingertip of your middle finger is touching the handlebar at the mid-point. If it is not as described then loosen the Fore-Aft adjustment knob and slide the handlebars forward or backward until your middle finger is touching the handlebar at the mid-point, and then retighten the handle.

The handlebar offers a wide variety of hand positions for personal preferences. Changing your hand position can change the angle of your back, neck, and arms. To minimize the stress on your muscles during your workouts, change your hand position frequently.

RESISTANCE ADJUSTMENT

The **preferred level of difficulty in pedalling** (resistance) can be regulated in fine increments by use of the resistance knob. To increase the resistance, turn the resistance knob clockwise. To decrease the resistance, turn the knob counter clockwise.

IMPORTANT: To stop the flywheel (wheel), pull the emergency brake handle upward. The flywheel should quickly come to a complete stop.



WARNING: The indoor cycle does not have a free moving flywheel (wheel); the pedals will continue to move together with the flywheel until the flywheel stops. Reducing speed in a controlled manner is required.

Resistance Knob
Emergency Brake Handle

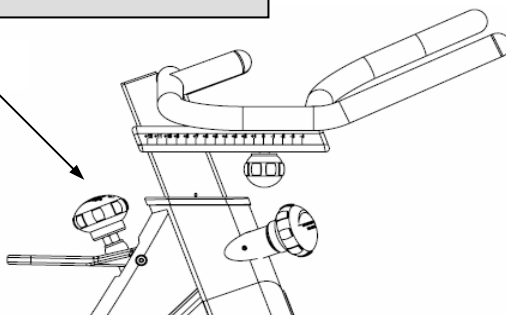

HOW TO MOVE THE INDOOR CYCLE

Due to the weight of the indoor cycle, it is recommended that two persons move it. While one person lifts the back of the indoor cycle, the second person firmly holds the handlebar and tips the indoor cycle forward until it rolls on the wheels. Carefully move the indoor studio cycle to the desired location and then lower it. **CAUTION: To reduce the risk of injury, use extreme caution while moving the indoor studio cycle. Do not attempt to move it over uneven surfaces.**

If the indoor cycle rocks on the floor after being set down, turn the levelling feet (see diagram) underneath the front or rear stabilizer until the rocking motion is eliminated.

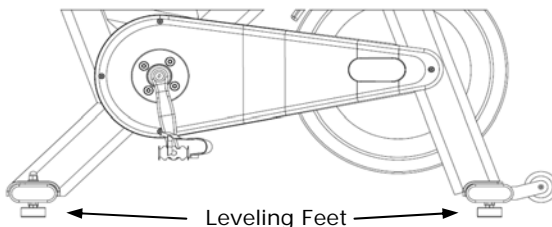

PREVENTIVE MAINTENANCE

Regular maintenance must be performed on the indoor cycle for optimal performance and longevity. Please read and follow all instructions below. If the indoor cycle is not maintained as described, components may wear excessively and the indoor cycle may become damaged. Improper maintenance will void the warranty terms. If you have questions about maintenance, contact your local distributor or refer to www.indoorcycling.com

Note: Many maintenance procedures require lubricant spray. Manufacturer recommends WD40, Brunox or any other solvent free lubricant.

DAILY MAINTENANCE

1. Make sure that the indoor cycle is level. If the indoor cycle rocks on your floor, turn the levelling feet underneath the front or rear stabilizer until the rocking motion is eliminated (see HOW TO MOVE THE INDOOR CYCLE on page 12).
2. After each user finishes exercising, the indoor cycle should be disinfected and cleaned to maintain a hygienic environment. First, apply a disinfectant spray to the handlebars and the saddle. Using a lint-free cloth, dry the handlebars and the saddle. Next, apply a small amount of disinfectant to a lint-free cloth and clean the adjustment knobs and the adjustment handles. Avoid using strong detergents on the indoor cycle frame.

WEEKLY MAINTENANCE

1. Apply a small amount of the lubrication spray to a lint-free cloth, and thoroughly clean the frame, the handlebar slider and seat sliders the flywheel and the plastic parts of the indoor cycle.

2. **(Picture A)** For optimal performance of the Resistance system, and to minimize wear on the brake pad, the solvent free lubricant spray should be applied to the brake pad using the lubrication holes on the plastic part of the brake pad. If fuzz or lint appears on the brake pad, the brake pad has become too dry—lubricant spray should be applied more frequently. Make sure brake pad is thoroughly soaked from end to end with lubricant spray. Then, wipe the excess off.

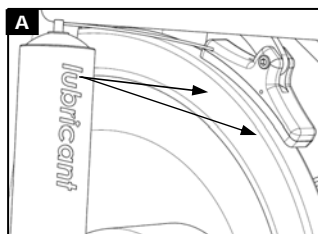

BI-WEEKLY MAINTENANCE

1. **(Picture B)** The indoor cycle should not be used if the Emergency Brake system is not working properly. While sitting on the saddle and pedalling, test the brake by pulling the emergency brake handle upward. The flywheel should come to a quick and complete stop.

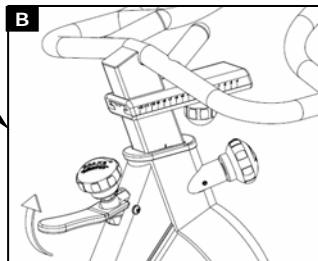

2. To maintain the easy adjustability of the saddle post, the saddle post should be cleaned and lubricated.

Turn the rear adjustment knob counter clockwise and slide the saddle post out of the frame. Apply a small amount of lubricant spray to a lint-free cloth, and clean the saddle post (**A**). Next, apply a small amount of lubricant spray inside of the rear frame sleeve. Then, reinsert the saddle post into the frame and adjust it to the desired height.

Next, loosen the rear adjustment knob and slide the saddle carriage as far backward as possible. Apply a small amount of lubricant spray to a lint-free cloth, and clean the top of the saddle slide (**B**). Then, slide the saddle carriage as far forward as possible and clean the top of the saddle slide. Finally, adjust the saddle to the desired position.

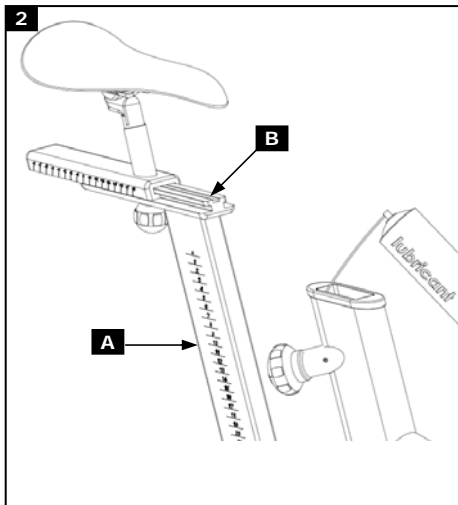

3. To maintain the easy adjustability of the handlebar post, the handlebar post should be cleaned and lubricated. First, turn the front adjustment knob counter clockwise and slide the handlebar post out of the frame. Apply a small amount of lubricant spray to a lint-free cloth, and clean the handlebar post (**A**). Next, apply a small amount of lubricant spray inside of the front frame sleeve.

Then, reinsert the handlebar post into the frame and adjust it to the desired height. Next, loosen the front adjustment knob and slide the handlebar carriage as far backward as possible. Apply a small amount of lubricant spray to a lint-free cloth, and clean the top of the handlebar slide (**B**). Then, slide the handlebar carriage as far forward as possible and clean the top of the handlebar slide. Finally, adjust the handlebar to the desired position.

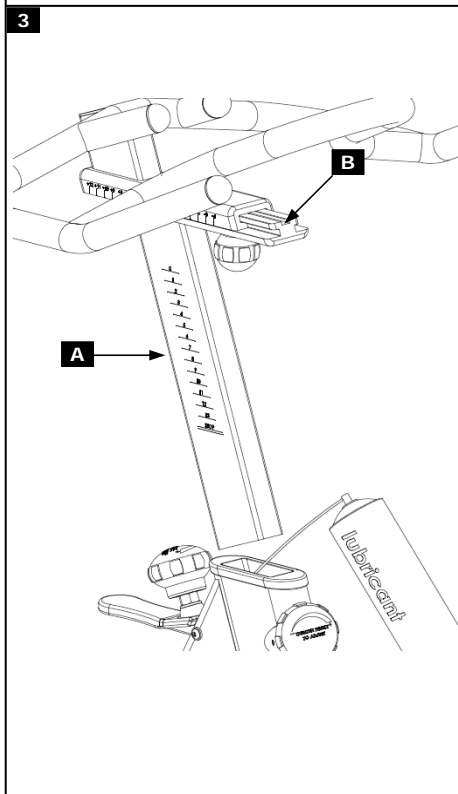

PREVENTIVE MAINTENANCE

MONTHLY MAINTENANCE

1. To maintain the smooth function of the adjustment knobs controlling the handlebar and saddle (4 knobs), the metal threads (A) on the adjustment knobs must be lubricated.

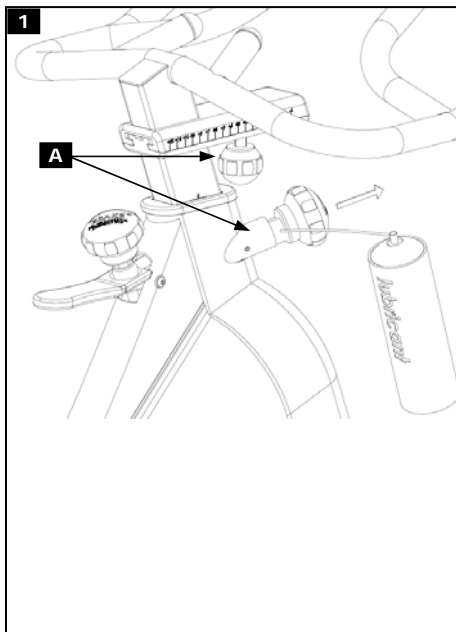

2. To maintain the easy adjustability of the Resistance system, the threads on the lower end of the brake rod should be lubricated.

First, turn the Resistance knob clockwise until it stops. Next, look under the right or left side of the frame and locate the brake rod, which has two Lock nuts on its lower end. Apply a small amount of synthetic grease (white lithium grease) to the threads on the brake rod above the two lock nuts. Then, turn the resistance knob counter-clockwise until it stops.

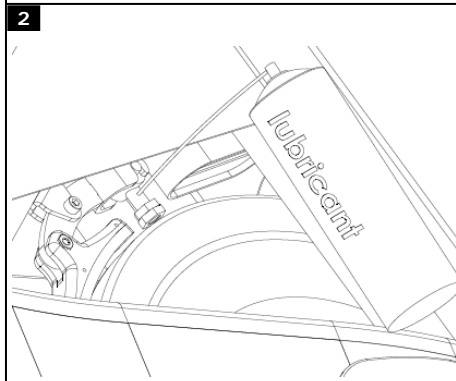

3a. Chain driven Bike

Check the amount of play in the chain. To do this, first sit on the saddle, place your feet on the pedals, and move the pedals until the crank arms are horizontal. Next, pull up the emergency brake handle and hold it. Then, stand on the pedals and rock forward and backward. There should be no more than 1/8th inch (2–3 mm) of play in the chain. If there is too much play in the chain, or if the chain makes a clicking noise, pull off the right and the left maintenance covers (A).

Loosen the axle nut (B) on both ends of the flywheel axle two full turns. Next, loosen the lock nuts (C) facing the head of the Allen bolt on each side of the flywheel.

Then, turn both (right and left sides) of the adjustment screws (D) on the inside of the flywheel bracket **1/4 of a turn at a time (tighter or looser)** until the chain is properly adjusted. **Make sure to turn both adjustment screws exactly the same amount to avoid misalignment of the flywheel.** Finally, retighten the two lock nuts and the two axle nuts, and reattach the maintenance covers. Re-check the amount of play in the chain as described at the beginning of this step. If necessary, readjust the chain.

Do not over tighten the axle nuts (B) to avoid damage to the flywheel bearings. Unusual noises or vibrations are indications that the chain has been over tightened or that the flywheel is at an angle.

3b. Belt Driven Bike

Check if belt is firmly tighten and does not slip while riding under resistance load. In case that the belt slips, proceed using the same technique as described above. Please note that a belt drive gear never shows slack.

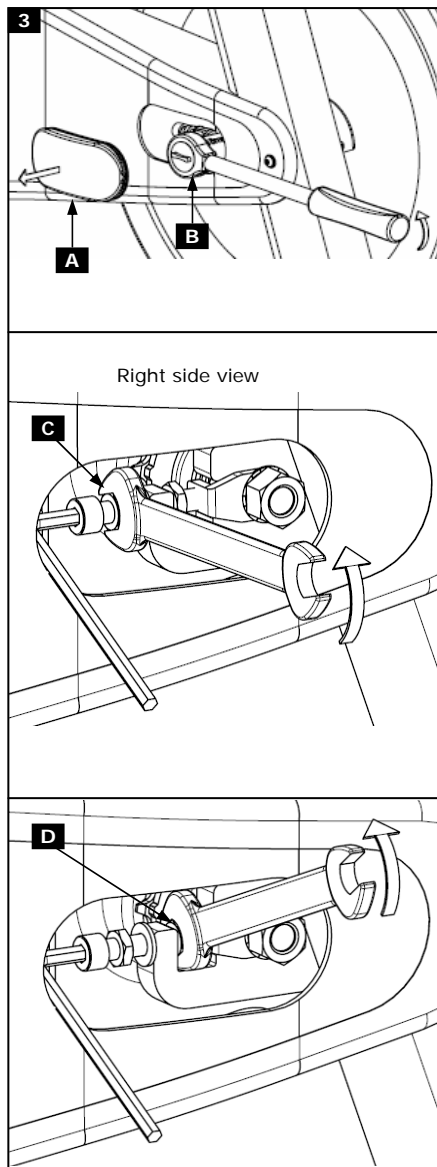

4. Check the chain for proper lubrication. To do this, run your fingers along the chain (not shown) in the service opening provided (A). **Make sure that the chain is not in movement during this check-up!**

If the chain feels dry, slowly turn the flywheel with one hand while equally applying a small amount of bicycle chain grease along the chain. To avoid injuring your hands, keep your hands away from moving parts.

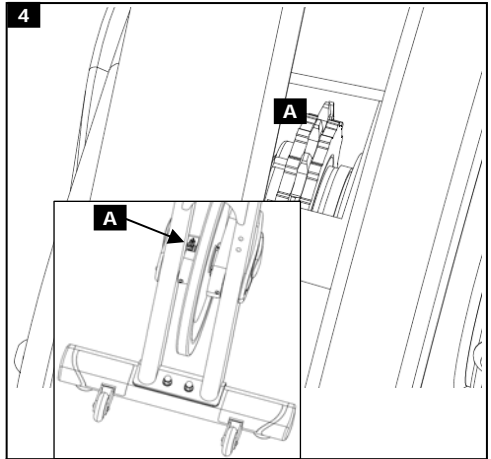

5. The brake pad will become worn as a result of repeated use. The indoor cycle should not be used if the emergency braking system is not working properly (see page 13)! Should you feel that the Resistance system's functions are deficient, it is essential to fine-tune the Resistance system before the bike is used again! Please check the setting of the brake system as follows: First turn the resistance regulator on the brake system as far as it will go to the left (minimum braking effect). If the setting is correct, the brake pads should be flush with the flywheel and barely touching so that it's possible to cycle with a hardly noticeable amount of resistance. The brake pad can be adjusted using a 10 mm wrench. Next, check the brake pad for signs of wear. If the brake pad does show signs of excessive wear, thoroughly soak the brake pad with lubricant spray using the 2 lubrication holes (B), and then wipe the excess off.

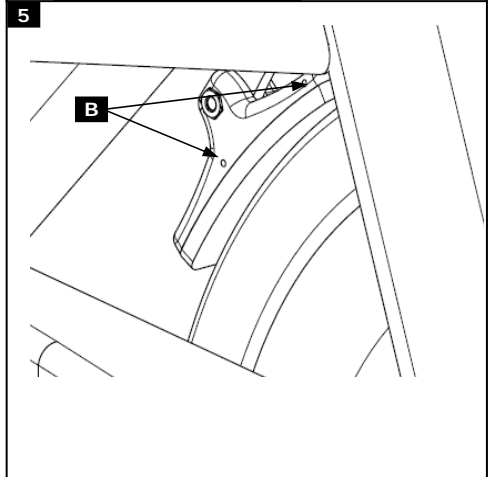

6. Some parts of the indoor cycle may become loose as a result of repeated use. Check pedals, toe clips, and pedal straps, and make sure that they are properly tightened. Next, check all exposed screws, bolts, and nuts, and make sure that they are properly tightened. Finally, check the saddle to make sure that it is not loose or damaged.

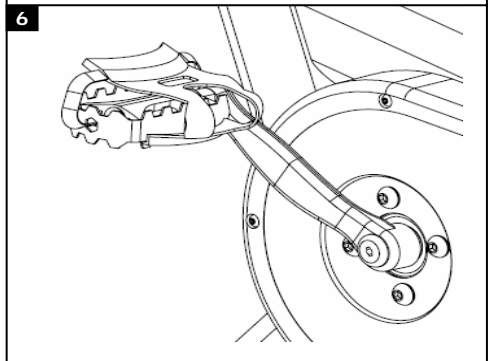

Maintenance Activity Required Schedule

Activity	Details found on page...	Daily	Weekly	Bi - weekly	Monthly
Feet leveling, disinfection and cleaning of the bike	13	X			
Servicing brake pads, detailed cleaning of the entire bike	13		X		
Check emergency brake function	13			X	
Clean and lubricate saddle and handlebar sliders / posts	14			X	
Check adjustment knobs	15				X
Check brake system, lubricate	15				X
Check chain play	16				X
Check chain lubrication	17				X
Check brake pad for signs of wear	17				X
Check pedals, toe clip and straps for signs of wear	17				X
Check all connections and fixings if they are secure and correctly tighten	17				X

Examples of Maintenance Plan Charts for in house service technicians:
(Examples of Weekly / Bi-Weekly / Monthly)

Weekly Maintenance Checklist					
Bike No.	Production code Bike	Observations	Action Taken	Result	Name / date
1					
2					
3					
4					
5					
6					
7					
8					
9					
10					
11					
12					
13					
14					
15					
16					
17					
18					
19					
20					
21					
22					
23					
24					
25					



USER'S MANUAL – S/X-SERIES

Bi-Weekly Maintenance Checklist

Bike No.	Production code Bike	Observations	Action Taken	Result	Name / date
1					
2					
3					
4					
5					
6					
7					
8					
9					
10					
11					
12					
13					
14					
15					
16					
17					
18					
19					
20					
21					
22					
23					
24					
25					

Monthly Maintenance Checklist

Bike No.	Production code Bike	Observations	Action Taken	Result	Name / date
1					
2					
3					
4					
5					
6					
7					
8					
9					
10					
11					
12					
13					
14					
15					
16					
17					
18					
19					
20					
21					
22					
23					
24					
25					

SPARE PARTS

Drive Gear Parts

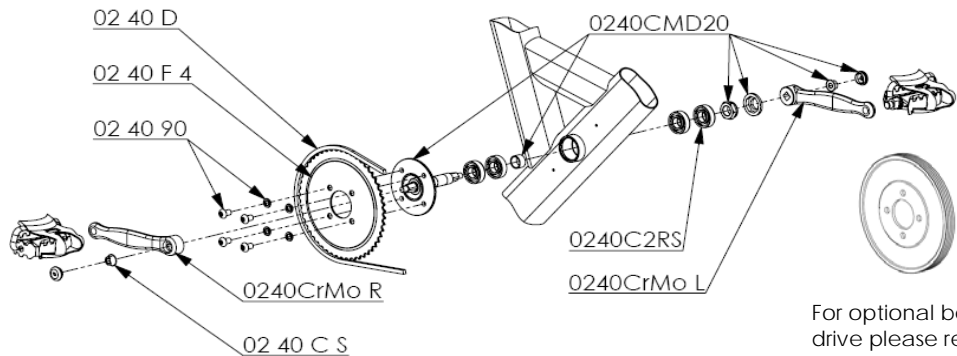

Brake Parts

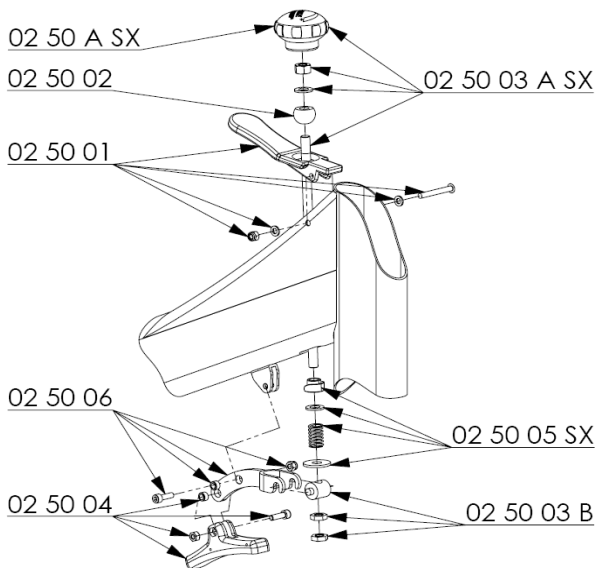

Flywheel

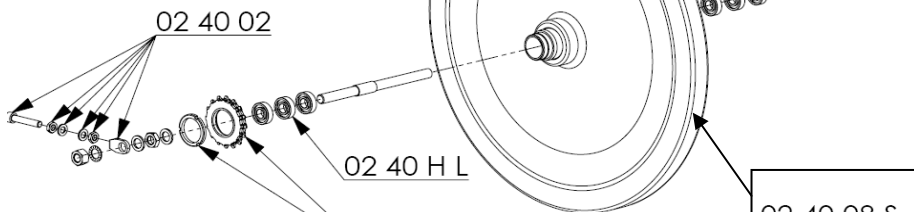
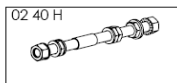

For optional belt drive please refer to page 23

Chain Guard

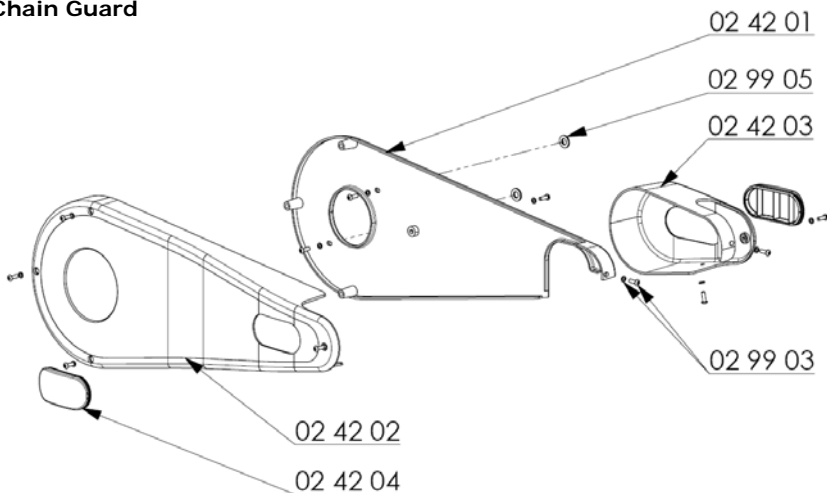

E-motion Kit

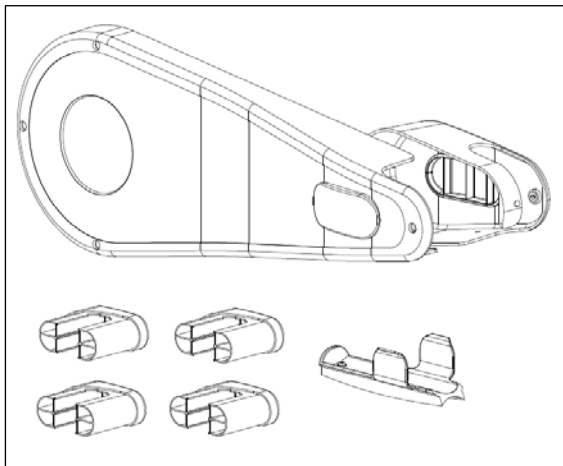

02 43 05 (red)

02 43 06 (white)

02 43 07 (green)

02 43 08 (yellow)

Frame

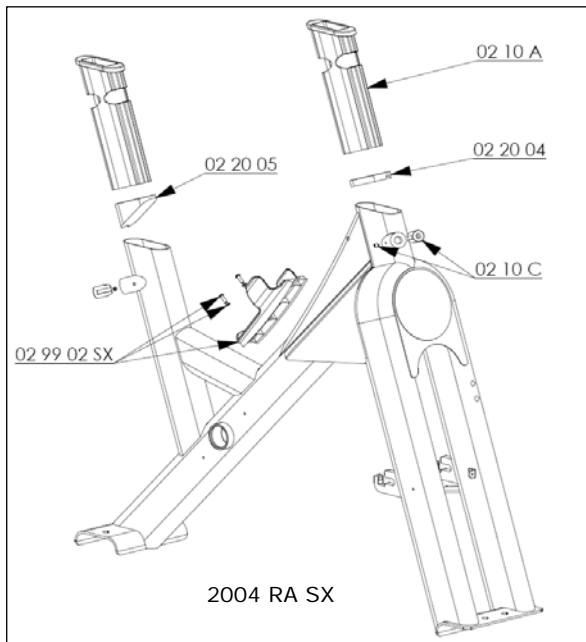

Belt Drive Kit

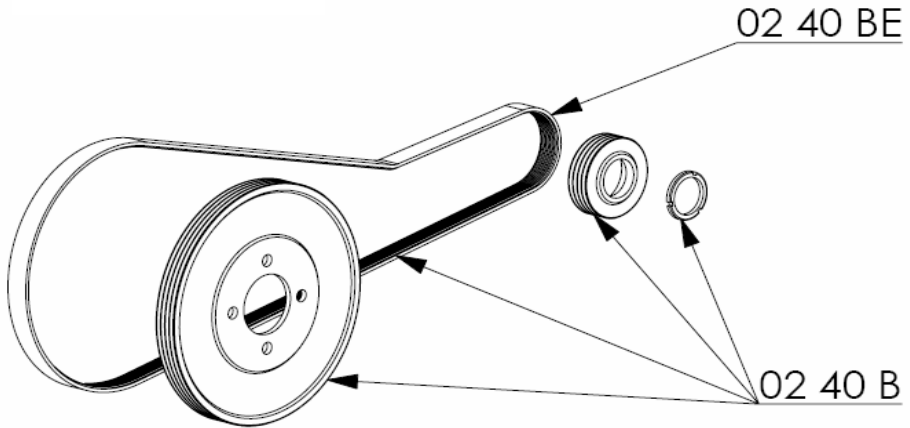

Sensitive Cycling Kit

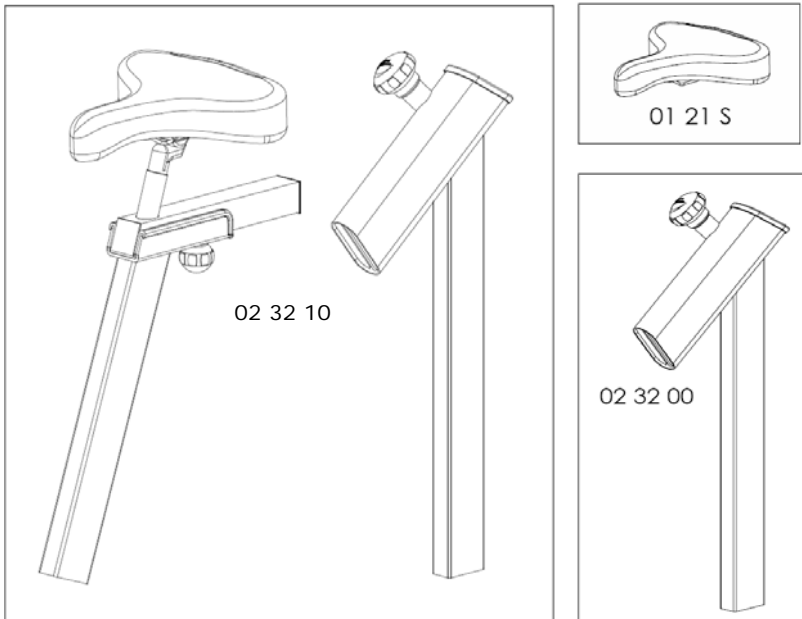

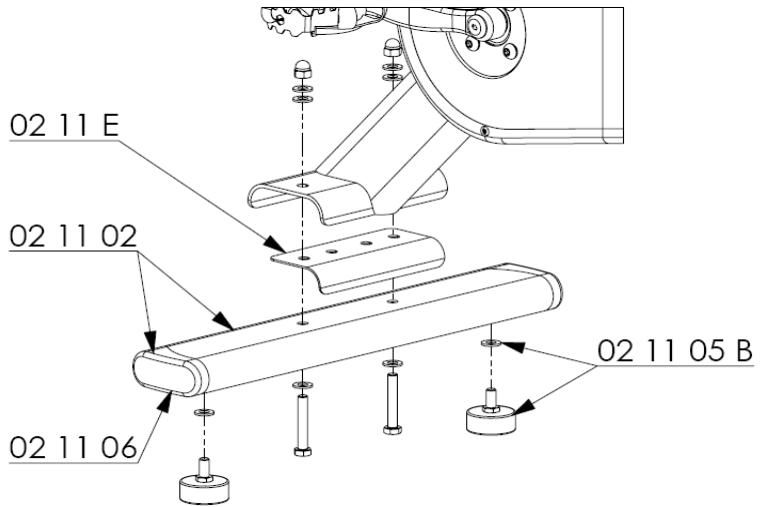
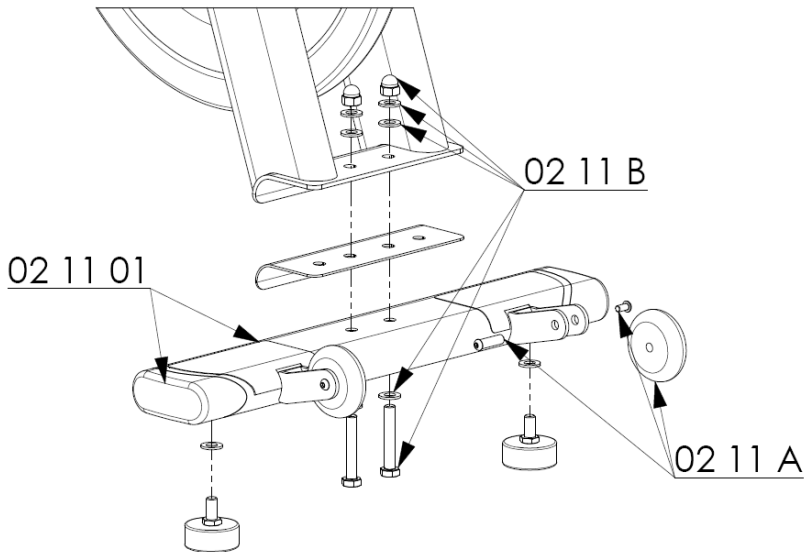
Rear Stabilizer**Front Stabilizer**

Protection Plates

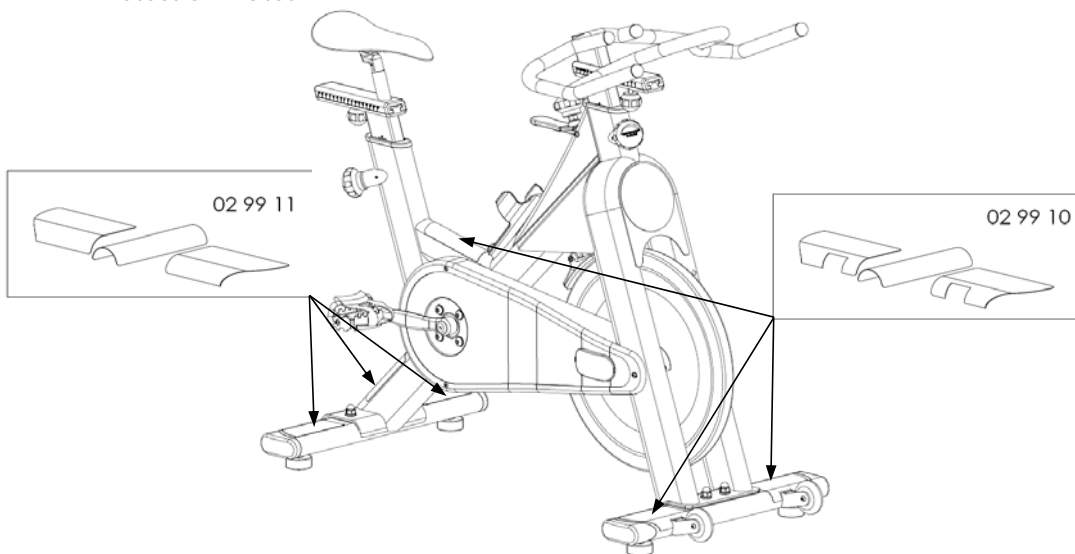

Saddle support

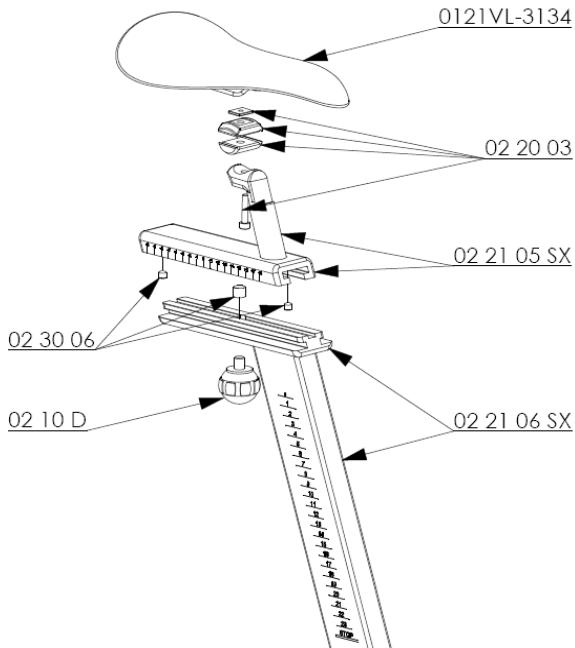

Handlebar

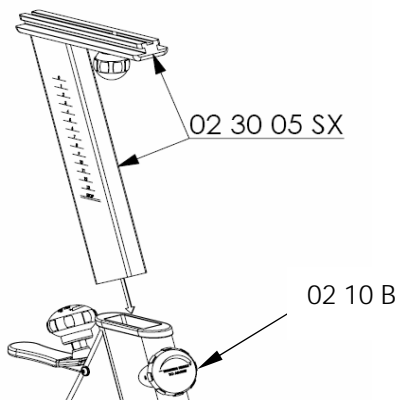
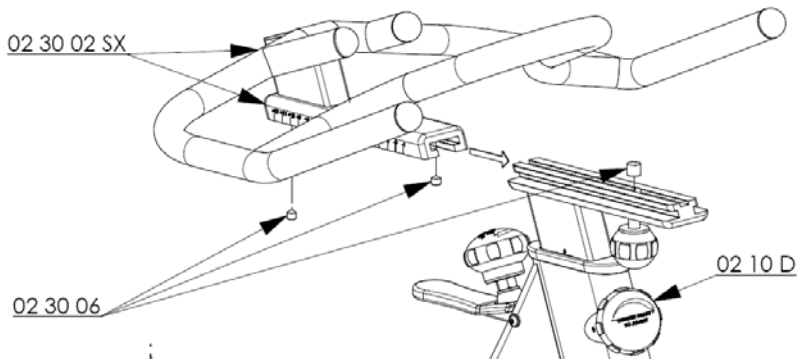

Pedals

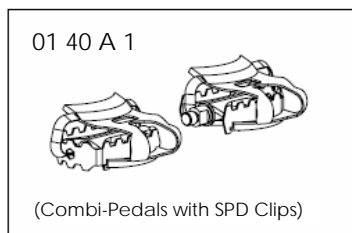
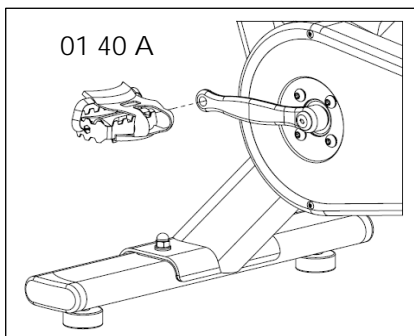

SPARE PARTS LIST

Part no.	Description	Part no.	Description
	Drive gear parts		E-motion Kits
02 40 D	Chain	02 43 05	E-motion Kit Red
02 40 F 4	Chain ring	02 43 06	E-motion Kit White
02 40 90	Chain ring bolt	02 43 07	E-motion Kit Green
02 40 CrMo R	Right crank	02 43 08	E-motion Kit Yellow
02 40 CrMo L	Left crank		Frame
02 40 C S	Flange nuts for crank	2004 RASX	S or X-Series Frame
02 40 CMD20	BB assembly MD20	02 10 A	Vertical insert sleeve
02 40 C 2 RS	Ball bearing SKF 6004Z	02 20 05	Rubber stop saddle tube
	Brake parts	02 20 04	Rubber stop handleb. tube
02 50 A SX	Brake adjustment knob	02 10 C	Push block
02 50 02	Adjustment ball		Belt drive kit
02 50 01	Emergency brake handle	02 40 B	Belt drive kit
02 50 06	Bell crank		Sensitive Cycling
02 50 04	Brake pad	02 32 10	Sensitive Cycling Kit
02 50 03 A SX	Upper brake rod	01 21 S	Sensitive Cycling saddle
02 50 05 SX	Lower brake system	02 32 00	Sensitive Cycling Module
02 50 03 B	Brake adjustment drum		Rear stabilizer
	Flywheel	02 11 E	PVC gasket
02 40 H	Flywheel axle	02 11 02	Rear stabilizer
02 40 02	Chain tensioner	02 11 06	Plastic end cover
02 40 H L	Flywheel bearing 6001Z	02 11 05 B	Rubber foot stand
02 40 E	16 cogs flywheel sprocket	02 99 11	Rear protection plates
02 40 08 S	S-Series flywheel		Front stabilizer
02 40 08 X	X-Series flywheel	02 11 01	Front stabilizer
02 40 08 SD	Smart Drive (X-Series)	02 11 B	Stabilizer mounting kit
	Chain Guard	02 99 10	Front protection plates
02 42 02	outer Chain guard	02 11 A	Transport wheel
02 42 04	Plastic cover		Saddle support
02 42 01	inner Chain guard	02 21 05 SX	Horizontal saddle support
02 99 05	Plastic washer	02 21 06 SX	Vertical saddle support
02 43 03	Left cover	02 10 B	Adjustment knob
02 99 03	Allen bolt M4x15	02 10 A	Vertical insert sleeve
	Pedals	0121VL3134	Velo Saddle
01 40 A 1	Combi-Pedals (Optional on S)	02 20 03	Saddle clamp
01 40 A	Standard Pedals on S Series		Handlebar
		02 30 05 SX	Vertical handlebar stem
	Accessories	02 30 02 SX	Handlebar
020110	EYE Computer (Optional)	02 30 06	Stop block
		02 10 D	Adjustment knob

Cytech GmbH warrants that all new equipment will be free of manufacturing defects in workmanship and materials, becoming effective on the date of original installation. Parts repaired or replaced under the terms of this warranty will be warranted for the remainder of the original warranty period only. **Warranty may vary by region or country.**

LIMITED WARRANTY **S-SERIES INDOOR CYCLE**

Limited Warranty

Parts are warranted to be free from defects in materials and workmanship for the duration of the warranty period as described below.

5 Year warranty: Frame construction, welding, seat and handlebar sliders; rubber sprocket, roll ring*

3 Year warranty: Brake system, Adjustment Knobs, Crank Arms, Drive Gear components, Bottom Bracket assembly, Flywheel hub assembly, Powder Coating

2 Year warranty: Combi-Pedals with SNCM 220 CNC (axle)*, Chain,

1 Year warranty: Saddle, Standard pedals (axle) Insert Sleeves for Saddle and Handlebar posts

Following parts are not covered under warranty and considered wear items:

Pedal straps, Brake Pads, Pedal Binding System, Toe clips, Seat Cover

(* optional items)

Limited warranty does not apply to:

1. Repairs performed on Product with missing, altered, or defaced serial numbers
2. Repair pick-up, delivery, or freight charges other than those specified below
3. Labor costs

LIMITED WARRANTY **X-SERIES INDOOR CYCLE**

Limited Warranty

Parts are warranted to be free from defects in materials and workmanship for the duration of the warranty period as described below.

5 Year warranty: Frame construction, welding, seat and handlebar sliders; rubber sprocket, roll ring, Brake system, Adjustment Knobs, Crank Arms, Drive Gear components, Bottom Bracket assembly, Flywheel hub assembly, Powder Coating

2 Year warranty: Combi-Pedals with SNCM 220 CNC (axle), Chain, Insert Sleeves for Saddle and Handlebar posts, SDS clutch (Smart Drive System)

1 Year warranty: Saddle, Standard pedals (axle), Insert Sleeves for Saddle and Handlebar posts

Following parts are not covered under warranty and considered wear items:

Pedal straps, Brake Pads, Pedal Binding System, Toe clips, Seat Cover

Limited warranty does not apply to:

1. Repairs performed on Product with missing, altered, or defaced serial numbers
2. Repair pick-up, delivery, or freight charges other than those specified below
3. Labor costs

TERMS AND CONDITIONS OF WARRANTY (*S & X SERIES*)

Terms and Conditions:

1. The expressed warranty is provided according to the guidelines listed below and applies on the S and X - Series only while:
 - a) proper assembly and maintenance as required in the Care and Maintenance Manual has been followed. (Important note: Improper assembly of the Product or improper maintenance will void the warranty terms)
 - b) it remains in the possession of the original purchaser and proof of purchase is demonstrated,
 - c) it has not been subject to accident, misuse, abuse, improper service or modification, and
 - d) claims are made within the warranty period
2. If a legitimate warranty claim is determined the local Product distributor will deliver or ship to you any new or rebuilt replacement part or component, or, at the option of the manufacturer, replace the Product. Any shipment cost incurred by the commercial client for the purpose of inspection of part by the local Product distributor will only be reimbursed after legitimacy of the claim is established by the manufacturer. Method of shipment must be approved in writing by local Product distributor prior mailing. In the case of non-legitimate claims the purchaser carries the cost of the replacement parts and the shipping.
3. This warranty does not cover damage or equipment failure caused by failure to provide required maintenance as outlined in this manual. Any failures or damage caused by unauthorized service, misuse, accident, negligence or improper assembly or installation; debris resulting from any construction or repair activities in the Product's environment; rust or corrosion as a result of the Product's location; alterations or modifications made without written authorization; or failure on your part to use, operate, and maintain the Product as set forth in this manual will void this warranty. **All terms of this warranty are void if the Product is moved beyond the country to which it was originally sold and are then subject to the terms provided by that country's local authorized Cytech GmbH representative.**
4. Cytech GmbH. Limited Warranty service can be obtained by contacting your local Product distributor. You can also reach us directly for support at www.indoorcycling.com.
5. Product limited warranty is void when Product is installed in a country other than where sold.

Your Responsibility

The purchaser is obligated to examine the goods immediately on delivery, for defects, otherwise the goods are considered approved and accepted. Retain proof of purchase; install, use, operate, and maintain the Product as specified in this manual; notify Customer Service of any defect within 10 days after discovery of the defect; and, if instructed, return any defective part for replacement, or, if instructed, return the entire Product for repair.

Placing a Warranty Claim

Simply contact your local Product distributor, provide them your name, address, and the serial number of your Product. A representative will assess the situation and take appropriate measures. If applicable you will be told how to get a replacement part.

TERMS AND CONDITIONS OF WARRANTY (*S & X SERIES*)

Exclusive Warranty

Cytech GmbH nor its distributors are responsible or liable for indirect, special, or consequential damages arising out of, or in connection with, the use or performance of the Product or damages with respect to any economic loss, loss of property, loss of revenues or profits, loss of enjoyment or use, costs of removal or installation, or other consequential damages of whatsoever nature. **Unauthorized Changes to Warranty**

The terms of this Limited Warranty cannot be changed, modified, or extended by anyone including local Product distributors without the signed acceptance by Cytech GmbH.

Country Laws

This warranty gives you specific legal rights according to European regulations and you may have other rights which vary from country to country.

Some countries may not allow the exclusion or limitation of incidental or consequential damages. Accordingly, the above limitation may not apply to you. The warranty extended hereunder is in lieu of any and all other warranties and any implied warranties of merchantability or fitness for a particular purpose is limited in its scope and duration to the terms set forth herein.

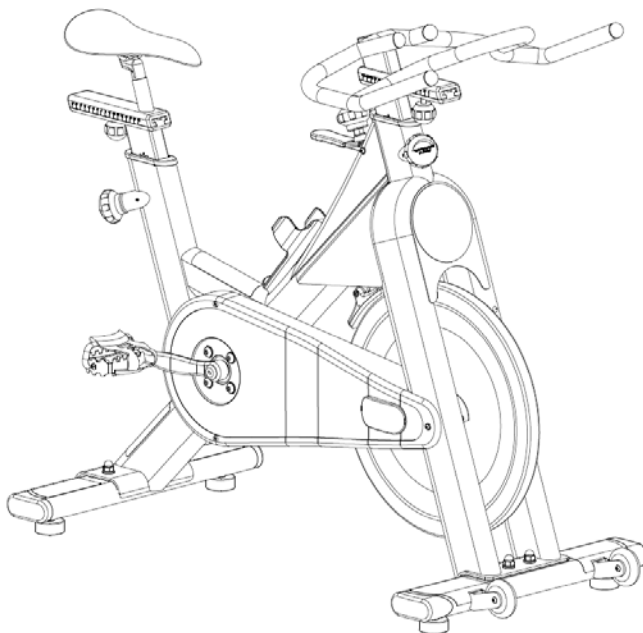

CYTECH GmbH
World Headquarter

Happurger Straße 84-88
90482 Nürnberg
Germany

Tel.: +49 (0) 911 54 44 50
Fax: +49 (0) 911 54 44 529

E-Mail: info@indoorcycling.com
www.indoorcycling.com
www.tomahawk.de